



PIMA COUNTY SHERIFF'S DEPARTMENT



COMMUNITY RESOURCES UNIT / SHERIFF'S AUXILIARY VOLUNTEERS Check Request Form

This form shall be used for all check requests from the Sheriff's Auxiliary Volunteers for the following funds designated for assistance to the Pima County Sheriff's Department. A specific funding source shall be named in the request.

- 2201 – Juvenile Activities Fund
- 2203 – Special Awards Fund
- 2206 – Building Maintenance Fund
- 2207 – Community Services Fund
- 2208 – Memorial Fund

CHECK REQUESTED BY: Lt. Gary Anderson

DATE: 06/15/10

CHECK REQUEST

PAY TO: Lowe's
 AMOUNT: ~~3100.90~~
 FUND SOURCE: Building Maintenance
 COMMENTS: Sheriff's Suite cabinets/remodel

FUND # 2206

REQUEST AUTHORIZATION

Community Rsrcs:

DATE: 6/17/10

Community Svcs:

DATE: 6/17/10

ROUTING: All checks issued from the aforementioned accounts shall be routed to the Community Resources Unit Supervisor prior to final disposition. The check will be logged and forwarded to the requestor, or the appropriate recipient, at the direction of the Community Resources Unit Supervisor.

SAV CORPORATE BOARD AUTHORIZATION

Approval: _____

DATE: _____

Check Signed By (1): _____

DATE: _____

Check Signed By (2): _____

DATE: 6-28-10

DISTRIBUTION

CR SGT: _____

DATE: _____

LOGGED BY: _____

DATE: _____

DISTRIBUTED TO/FOR ORIGINATOR

DATE: _____

SHERIFF'S AUXILIARY
VOLUNTEERS OF PIMA COUNTY, INC.
1750 E. BENSON HIGHWAY
TUCSON, AZ 85714-1758

JPMORGAN CHASE BANK, NA
TUCSON, AZ 85737
91-2/1221

13020

6/28/2010

PAY TO THE ORDER OF Lowe's

\$ **3,100.90

Three Thousand One Hundred and 90/100 *****

DOLLARS

Lowe's

TWO SIGNATURES REQUIRED

MEMO #2206

⑆0⑆3020⑆ ⑆2200024⑆ 24444247⑆



MEMORANDUM

PIMA COUNTY SHERIFF'S DEPARTMENT
CLARENCE W. DUPNIK, SHERIFF

Date: June 15, 2010

To: Lt. Gary Anderson, Commander, Material Management Section,

From: Anthony Fichera, Material Management Section

Re: Sheriff's Suites Kitchen Remodel and the Installation of a Flat Screen Tv and Surround Sound System in the Conference Room

To facilitate the ongoing refurbishment of the Sheriff's Administration Building these various tools and materials will be needed to remodel the kitchen in the Sheriff's Suites. Refer to the attached sheet(s) for specific information on requested items. The total cost of this/these item(s) is \$ 3100.90

I am requesting funding for this/these item(s) from the SAV account. To be purchased at the Lowes. Thanks for your attention and consideration of this request.

Attachment

RECOMMEND APPROVAL; ORIGINAL ESTIMATE
WAS \$3806.13, A SAVINGS OF OVER \$700.00.

[Signature]
6-15-10

Approved
SAV Faculty
Fund
M. Mallo

Build. Maint
Fund
[Signature]
6/17

867-5641

Fax 351-4793

OMZR130A

LOWE'S HIW, INC.
MRA 1707

PAGE: 1

PROJECT ESTIMATE

ESTIMATE FOR SHERIFF'S DEPARTMENT / REVISED

CONTACT: SHERIFF SUIT, PIMA COUNTY
CUST #: 80463034

SALESPERSON: FORSYTH, BILL
SALES #: 118844

Bill
Tony

PROJECT NUMBER: 295549838

DATE ESTIMATED: 06/15/10

QTY	ITEM #	ITEM DESCRIPTION	VEND PART #	PRICE
1	292653	KC 24"X30" MERLOT WC CODE D	30A W2430R	104.30
0	160450	KC 30"X18" MERLOT WC CODE T	30A W3018	0.00
3	292943	KC 30"X30" MERLOT WC CODE F	30A W3030	388.50
1	293011	KC 36"X12" MERLOT WC CODE H	30A W3612	91.82
1	160394	KC 36" MERLOT BASE CAB CODE P	30A B36	199.22
1	160392	KC 18" MERLOT DRWR BASE CODE S	30A DB18	177.15
1	160438	KC 36" MERLOT SINK BASE CODE Q	30A SB36	167.48
1	160391	KC 30" MERLOT BASE CAB CODE O	30A B30	182.26
2	162195	KC 8' MERLOT TORKICK CODE TK	30A TORKTCK8	25.76
5	163305	KC 3"X36" MERLOT FILLER CODE F	30A F336	83.45
2	162652	KC 96" MERLOT SCRIBE MLDG CODE	30A MSW8	20.94
1	255517	6' ML MILANO QUARTZ TOP BEL	4726116L	54.70
1	255524	10' MR MILANO QUARTZ TOP DEL	47261110R	87.22
1	255527	MILANO QUARTZ ENDCAP KIT BEL	472611RCK	8.39
1	255528	MILANO QUARTZ ENDSPL KIT BEL	472611RCEBK	14.04
1	95077	MITER JOINT KIT BEL	MBK	4.90
25	98505	SATIN NICKEL 3" SPLIT ARCH PUL	BP19259-G10	71.50
1	292659	KC 30"X12" MERLOT WC CODE G	30A W3012	83.79
1	284131	GB EASY FINISH JC 47LB CTN	JT0061	6.31
1	218686	DRYWALL SAND SCREEN #220 25PK	7107	13.98
1	246696	DRYWALL SAND SCREEN 80# 25PK	7119	15.11
1	245662	KOBALT INSIDE CORNER TROWEL 179	8083	6.28
6	4511	1X2X8 PREMIUM FURRING STRIP		32.40
6	26818	2X4X96 KD HEM-FTR SELECT STUD	4368	15.12
1	172416	1-1/2 END OUTLET DISPOSER KIT	334BK	4.93
1	31900	1-1/2 OR 1-1/4 X 1-1/2 P TRAP	400BK	1.72
3	56497	ANGLE VALVE 5/8"OD X3/8"OD	K2622PC	14.01
0	250010	PRECISEFIT VARIBL PW SPRAY NOZ	SGY-PWA14	0.00
1	25113	3/8"C X 12" SS TOILET SUPPLY L	LBLK SPCT12-	2.93
1	70012	12-2 COPPER NM/WG INDOOR 25'	28828221	12.89
1	75637	3/8 NM CONNECTOR 10 BAG	45650	2.39
0	188293	1/4' DRIVE 6 FT DREP SOCKET-13	22733	0.00
1	188923	15A 125V SINGLE OUTLET LT ALMO	5251LACC8	2.47
2	25110	3/8"C X 20" SS FAUCET SUPPLY L	LBLK SPC20-6	7.26
1	71006	1 5/8" GOLD SCREW 1 LB 158GSL	10901	4.16
1	70535	2 1/2" GOLD SCREW 1 LB 212GSL	10931	4.16
1	70427	3" GOLD SCREW 1 LB 30GSL	10946	4.16
6	11730	1/2 4X8 GYPSUM REGULAR	752278212080	29.76
2	240222	6PK NICKEL 20W PUCK LT W/DIMM	25806NKL120D	63.20
1	259532	OVER-THE-RANGE	RVM1535DMCC	150.33
1	196548	STRNR SS TWIST AND LOCK BSKT	K5410	9.79
1	225677	DISPOSER SINK TOP SWITCH USE	STS-SO	59.94
1	211213	SS 8" DB DUALMNT 20G ELKAY	LNS33224	179.00
1	297850	STAINLESS IH HIGH ARC PULL-OUT	P88102LRF-SSS	123.34
1	109794	1/3HP DISPOSER 1YR WARRANTY IS	BADGER 1	67.18
2	124206	6' STEREO CABLE DIGITAL+	DH6SA	13.94
4	113837	(252767)9FT 3.1 HDMI DIGITAL+	DH9HH	79.68
2	248218	SPFAKER CONNECTION KIT ALM OQ	F9008-DM-V1	35.94

PROJECT ESTIMATE

ESTIMATE FOR SHERIFF'S DEPARTMENT / REVISED

CONTACT: SHERIFF SUIT, PIMA COUNTY
CUST #: 80463034

SALESPERSON: FORSYTH, BILL
SALES #: 118844

PROJECT NUMBER: 295549838

DATE ESTIMATED: 06/15/10

QTY	ITEM #	ITEM DESCRIPTION	VEND PART #	PRICE
2	256501	1G OLD WORK LOW VOLT BRKP	F9060-01-V9	2.30
2	15805	CABLE ACCESS WALL PLATE	WP1014-WH-V1	11.06
0	18572	14/2 SPEAKER WIRE CLEAR LFT	94607L418	0.00
50	18571	16/2 SPEAKER WIRE CLEAR LFT	94605L418	17.00
0	306199	HITACHI 12V LI-TON COMBO RT	KC10DFL	0.00
1	34	1.0 QT DSH GARDEN		11.48
TOTAL FOR ITEMS				2769.84
FREIGHT CHARGES				0.00
DELIVERY CHARGES				79.00
TAX AMOUNT				252.06
TOTAL ESTIMATE				3100.90

This Quote is valid until 07/15/10.

MANAGER SIGNATURE _____ DATE _____

THIS ESTIMATE IS NOT VALID WITHOUT MANAGER'S SIGNATURE.
THIS IS AN ESTIMATE ONLY. DELIVERY OF ALL MATERIALS CONTAINED IN THIS ESTIMATE ARE SUBJECT TO AVAILABILITY FROM THE MANUFACTURER OR SUPPLIER. QUANTITY, EXTENSION, OR ADDITION ERRORS SUBJECT TO CORRECTION. CREDIT TERMS SUBJECT TO APPROVAL BY LOWES CREDIT DEPARTMENT.

LOWES IS A SUPPLIER OF MATERIALS ONLY. LOWES DOES NOT ENGAGE IN THE PRACTICE OF ENGINEERING, ARCHITECTURE, OR GENERAL CONTRACTING. LOWES DOES NOT ASSUME ANY RESPONSIBILITY FOR DESIGN, ENGINEERING, OR CONSTRUCTION; FOR THE SELECTION OR CHOICE OF MATERIALS FOR A GENERAL OR SPECIFIC USE; FOR QUANTITIES OR SIZING OF MATERIALS; FOR THE USE OR INSTALLATION OF MATERIALS; OR FOR COMPLIANCE WITH ANY BUILDING CODE OR STANDARD OF WORKMANSHIP.

PROJECT ESTIMATE

ESTIMATE FOR SHERIFF'S DEPARTMENT

CONTACT: SHERIFF SUIT, PIMA COUNTY
CUST #: 80463034

SALESPERSON: FORSYTH, BILL
SALES #: 118844

PROJECT NUMBER: 295549838

DATE ESTIMATED: 06/11/10

QTY	ITEM #	ITEM DESCRIPTION	VEND PART #	PRICE
1	292653	KC 24"X30" MERLOT WC CODE D	30A W2430R	149.00
0	160450	KC 30"X18" MERLOT WC CODE T	30A W3018	0.00
3	292943	KC 30"X30" MERLOT WC CODE E	30A W3030	555.00
1	293011	KC 36"X12" MERLOT WC CODE H	30A W3612	127.00
1	160394	KC 36" MERLOT BASE CAB CODE P	30A B36	264.00
1	160392	KC 18" MERLOT DRWR BASE CODE S	30A DB18	236.00
1	160438	KC 36" MERLOT SINK BASE CODE Q	30A SB36	204.00
1	160391	KC 30" MERLOT BASE CAB CODE O	30A B30	257.00
2	162195	KC 8' MERLOT TOEKICK CODE TK	30A TOEKICK8	32.56
5	163305	KC 3"X36" MERLOT FILLER CODE F	30A F336	83.45
2	162652	KC 96" MERLOT SCRIBE MLDG CODE	30A MSW8	26.84
1	255517	6' ML MILANO QUARTZ TOP BEL	4726116L	68.00
1	255524	10' MR MILANO QUARTZ TOP BEL	47261110R	105.00
1	255527	MILANO QUARTZ ENDCAP KIT BEL	472611ECK	11.98
1	255528	MILANO QUARTZ ENDSPL KIT BEL	472611RCEsk	18.98
1	95077	MITER BOLT KIT BEL	MBK	7.00
25	98505	SATIN NICKEL 3" SPLIT ARCH PUL	BP19259-G10	74.50
1	292659	KC 30"X12" MERLOT WC CODE G	30A W3012	119.00
1	284131	GB EASY FINISH JC 47LB CTN	JT0061	6.87
1	218686	DRYWALL SAND SCREEN #220 25PK	7101	19.97
1	246696	DRYWALL SAND SCREEN 80# 25PK	7119	19.97
1	245662	KOBALT INSIDE CORNER TROWEL (79	8083	8.97
6	4511	1X2X8 PREMIUM FURRING STRIP		6.72
6	26818	2X4X96 KD HEM-FIR SELECT STUD	4368	15.12
1	172416	1-1/2 END OUTLET DISPOSER KIT	334BK	7.02
1	31900	1-1/2 OR 1-1/4 X 1-1/2 P TRAP	400BK	2.35
3	56497	ANGLE VALVE 5/8"OD X3/8"OD	K2622PC	20.01
0	250010	PRECISEFIT VARIABL PW SPRAY NOZ	SGY-PWA14	0.00
1	25113	3/8"C X 12" SS TOILET SUPPLY L	LBLK SPCT12-	4.18
1	70012	12-2 COPPER NM/WG INDOOR 25'	28828221	18.42
1	75637	3/8 NM CONNECTOR 10 BAG	45650	3.23
0	188293	1/4' DRIVE 6 PT DEEP SOCKET-13	22733	0.00
1	188923	15A 125V SINGLE OUTLET LT ALMO	5251LACC8	2.97
2	25110	3/8"C X 20" SS FAUCET SUPPLY L	LBLK SPC20-6	10.36
1	71006	1 5/8" GOLD SCREW 1 LB 158GS1	10901	5.94
1	70535	2 1/2" GOLD SCREW 1 LB 212GS1	10931	5.94
1	70427	3" GOLD SCREW 1 LB 3GS1	10946	5.94
6	11730	1/2 4X8 GYPSUM REGULAR	752278212080	41.88
2	240222	6PK NICKEL 20W PUCK LT W/DIMM	25806NKL120D	69.96
1	259532	OVER-THE-RANGE	RVM1535DMCC	159.00
1	196548	STRNR SS TWIST AND LOCK BSKT	K5410	13.98
1	225677	DISPOSER SINK TOP SWITCH ISE	STS-SO	59.94
1	211213	SS 8" DB DUALMNT 20G ELKAY	LNS33224	179.00
1	297850	STAINLESS 1H HIGH ARC PULL-OUT	P88102LF-SSS	138.00
1	109794	1/3HP DISPOSER 1YR WARRANTY IS	BADGER 1	79.96
2	124206	6' STEREO CABLE DIGITAL+	DH6SA	13.94
4	113837	(252767)9FT 3.1 HDMI DIGITAL+	DH9HH	79.88
2	248218	SPEAKER CONNECTION KIT ALM OQ	F9008-DM-V1	35.94

PROJECT ESTIMATE

ESTIMATE FOR SHERIFF'S DEPARTMENT

CONTACT: SHERIFF SUIT, PIMA COUNTY
CUST #: 80463034

SALESPERSON: FORSYTH, BILL
SALES #: 118844

PROJECT NUMBER: 295549838

DATE ESTIMATED: 06/11/10

QTY	ITEM #	ITEM DESCRIPTION	VEND PART #	PRICE
2	256501	1G OLD WORK LOW VOLT BRKT	F9060-01-V9	2.56
2	15805	CABLE ACCESS WALL PLATE	WP1014-WH-V1	14.42
0	18572	14/2 SPEAKER WIRE CLEAR LFT	94607L418	0.00
50	18571	16/2 SPEAKER WIRE CLEAR LFT	94605L418	24.50
TOTAL FOR ITEMS				3416.25
FREIGHT CHARGES				0.00
DELIVERY CHARGES				79.00
TAX AMOUNT				310.88
TOTAL ESTIMATE				3806.13

This Quote is valid until 07/11/10.

MANAGER SIGNATURE

DATE

THIS ESTIMATE IS NOT VALID WITHOUT MANAGER'S SIGNATURE.
THIS IS AN ESTIMATE ONLY. DELIVERY OF ALL MATERIALS CONTAINED IN THIS ESTIMATE ARE SUBJECT TO AVAILABILITY FROM THE MANUFACTURER OR SUPPLIER. QUANTITY, EXTENSION, OR ADDITION ERRORS SUBJECT TO CORRECTION. CREDIT TERMS SUBJECT TO APPROVAL BY LOWES CREDIT DEPARTMENT.

LOWES IS A SUPPLIER OF MATERIALS ONLY. LOWES DOES NOT ENGAGE IN THE PRACTICE OF ENGINEERING, ARCHITECTURE, OR GENERAL CONTRACTING. LOWES DOES NOT ASSUME ANY RESPONSIBILITY FOR DESIGN, ENGINEERING, OR CONSTRUCTION; FOR THE SELECTION OR CHOICE OF MATERIALS FOR A GENERAL OR SPECIFIC USE; FOR QUANTITIES OR SIZING OF MATERIALS; FOR THE USE OR INSTALLATION OF MATERIALS; OR FOR COMPLIANCE WITH ANY BUILDING CODE OR STANDARD OF WORKMANSHIP.

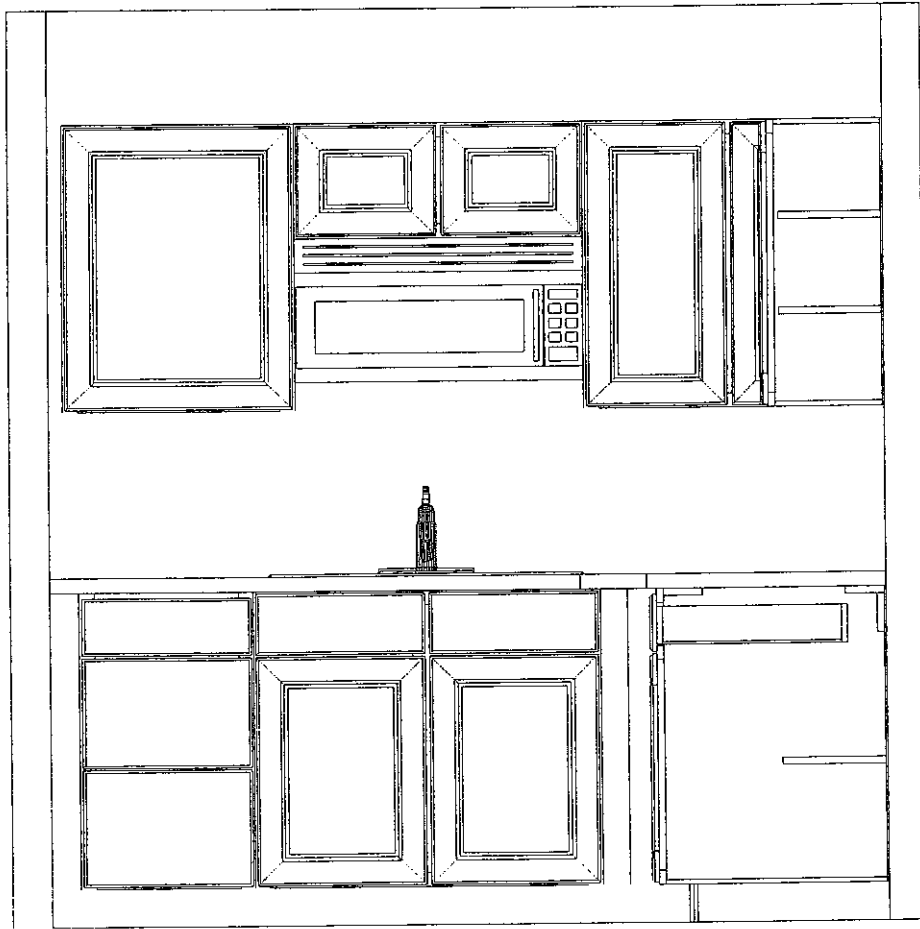

Note: This drawing is an artistic interpretation of the general appearance of the design. It is not meant to be an exact rendition.



Designed: 6/11/2010
Printed: 6/11/2010

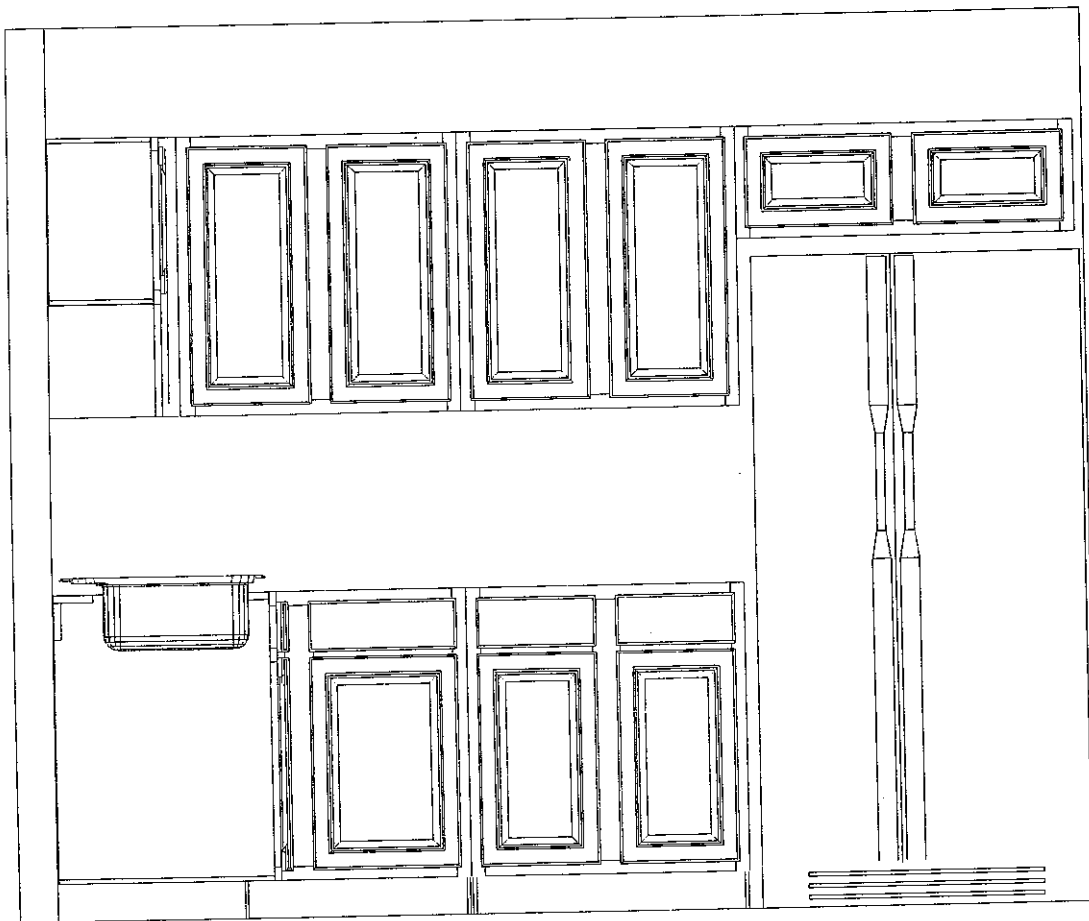

Note: This drawing is an artistic interpretation of the general appearance of the design. It is not meant to be an exact rendition.



Designed: 6/9/2010
Printed: 6/9/2010

bf Pima County Sheriff suit.kit

All

Drawing #: 1

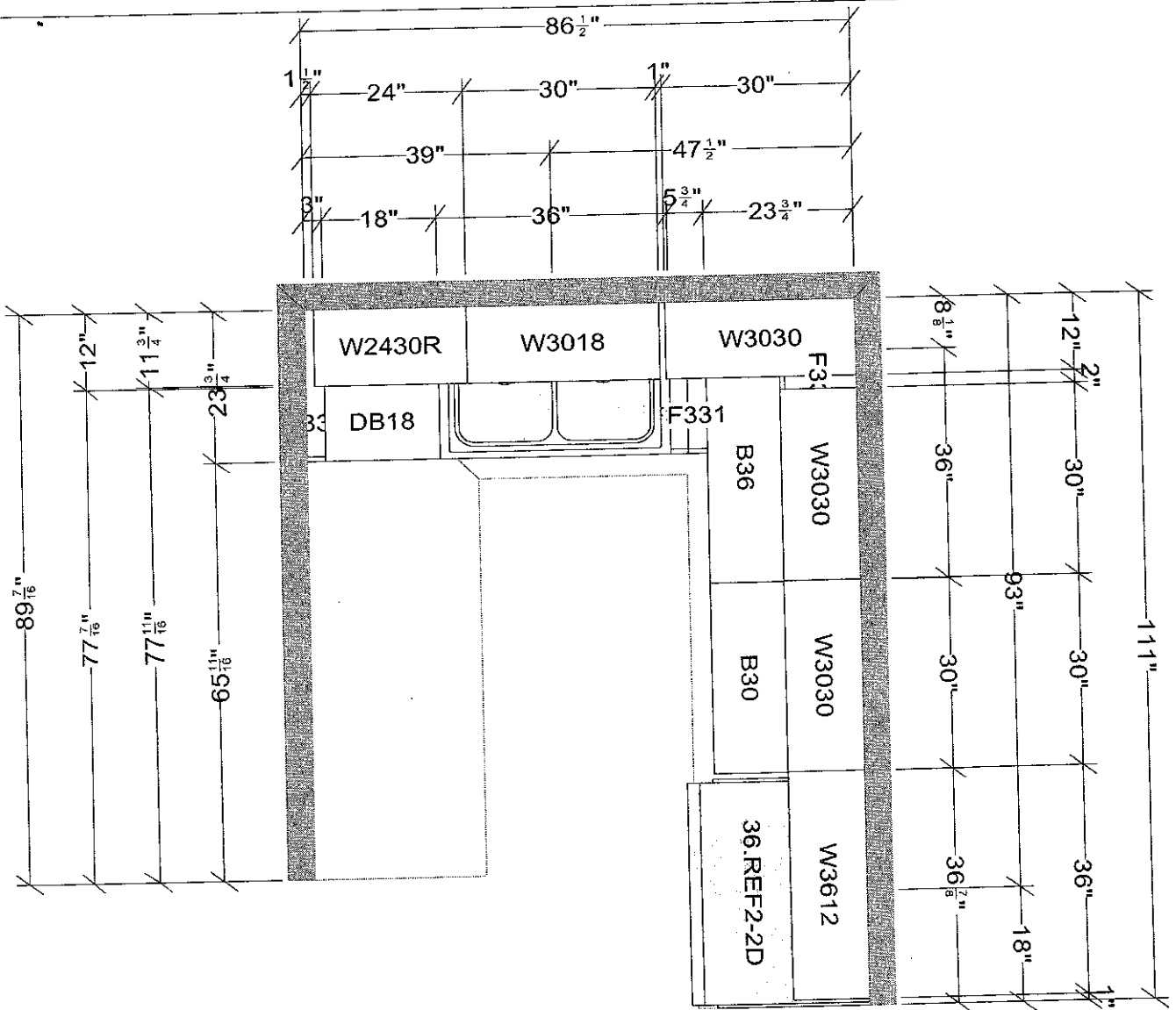

All dimensions, size designations given are subject to verification on job site and adjustment to fit job conditions.



This is an original design and must not be released or copied unless applicable fee has been paid or job order placed.

Designed: 6/9/2010
Printed: 6/9/2010

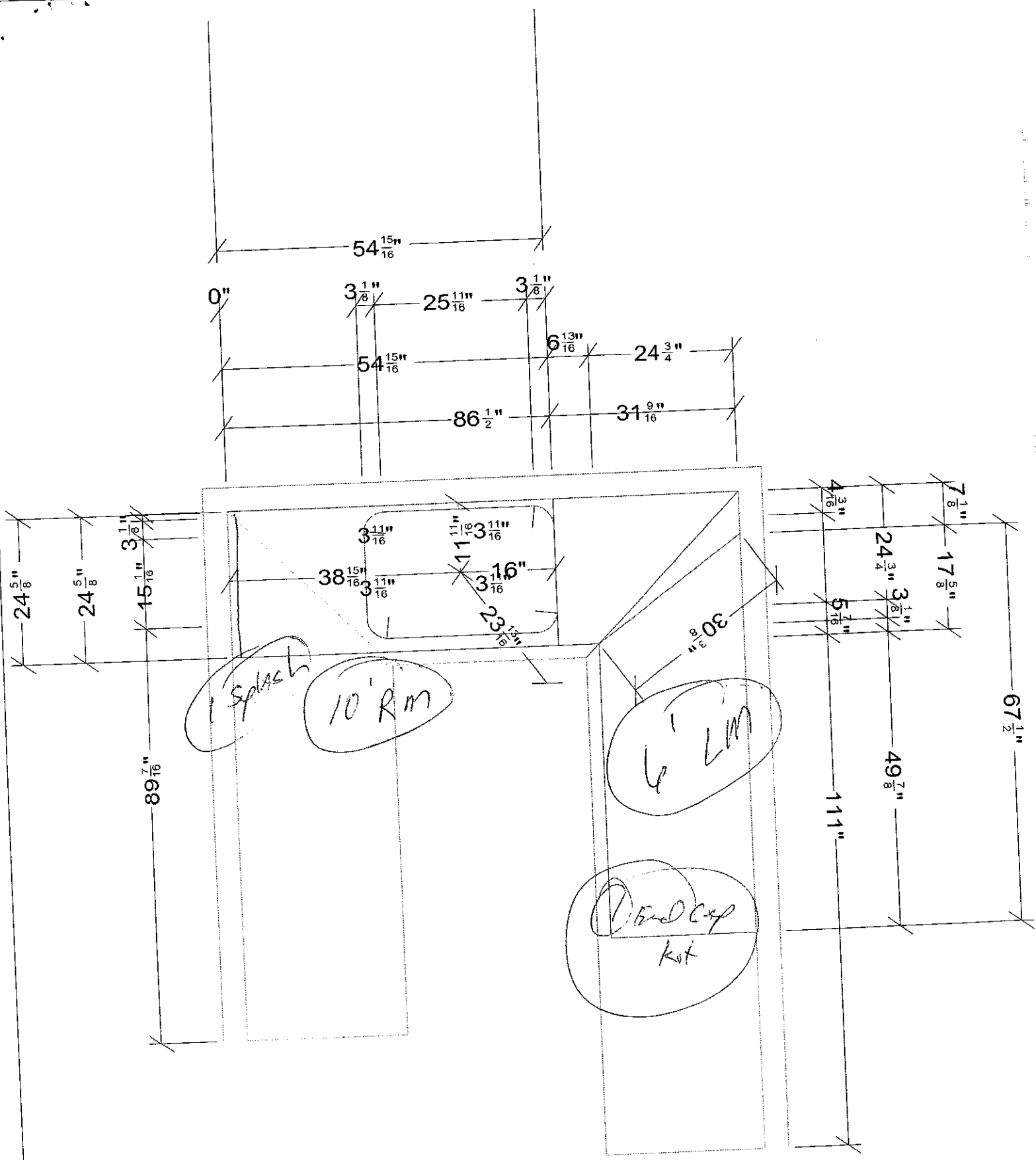

All dimensions size designations given are subject to verification on job site and adjustment to fit job conditions.



This is an original design and must not be released or copied unless applicable fee has been paid or job order placed.

Designed: 6/9/2010
Printed: 6/9/2010

Date: 15 June 2010

Action Completed		To	Unit/Division	Suspense Date	Action
Initial	Date				
<i>[Signature]</i>	6/16	Captain C. Radtke	Administrative Services Division Commander		5
<i>[Signature]</i>	6/17 For →	Lieutenant J. Berry	Community Services Section		10
Remarks:			Actions 1- For Your Information 2- Information & Return 3- Information & Forward 4- Comment & Return 5- Comment & Forward 6- Signature & Return 7- Signature & Forward 8- Investigate & Reply 9- Per Your Request 10- Take Appropriate Action 11- See Me 12- Other (See Remarks)		